



DC analogue voltmeters

Indicators and transducers



voltm_015.eps

Compliance with standards

- > IEC 60051-1
- > IEC 60414
- > NF EN 60051-1
- > DIN 43780
- > NF C 42-010
- > VDE 0410
- > BS 5448
- > BS 89



Function

SOCOME **magnetic-electric voltmeters** measure the DC voltage on any electrical circuit.

They are embedded in the front panel of cabinets, enclosures or other equipment.

Characteristics

- Pointer deflection: 90°.
- Insulating voltage: 660 V.
- Dielectric quality: 2 kV - 50 Hz - 1 mn.
- Consumption: internal resistance 1000 Ω/V.
- Any voltage above 600 V requires a voltage divider.
- Connection: screw or fast-on lugs.
- Interchangeable guided dial (needle protection).

Composition of the range

Case	DIN 48-72-96	ROTEX 72
Pointer deflection	90°	90°
Rating		
0 - 25 - 250 V	•	•
0 - 400 - 500 V	•	•

Case

DIN

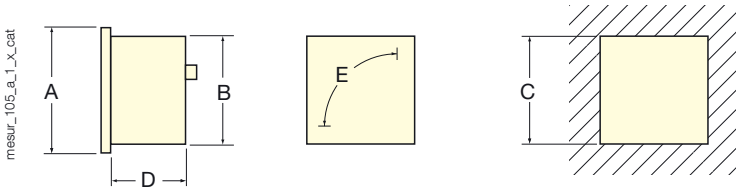

Pointer deflection: 90°				
A	B	C	D	E
48 x 48	44.5 x 44.5	45 ^{+0.6}	59	38
72 x 72	66.5 x 66.5	68 ^{-0.7}	58	65
96 x 96	89 x 89	92 ^{-0.8}	58	100

ROTEX

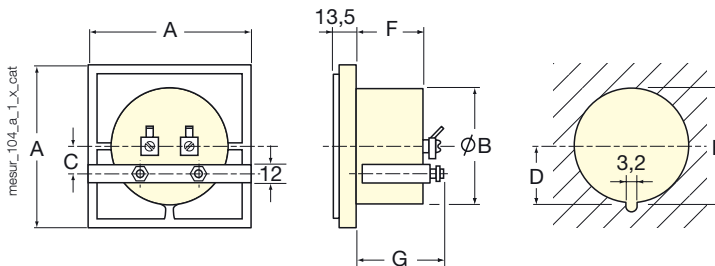

Pointer deflection: 90°						
A	B	C	D	E	F	G
72 x 72	54.5	11	28.5	56 ^{±0.5}	34.5	50.8

Connections

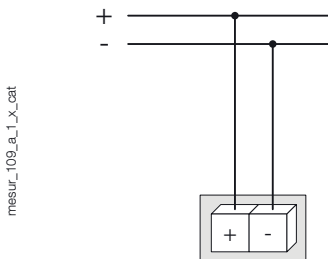

References

Rating	Direct connection			
	DIN 48x48 D48C90-V	DIN 72x72 D72C90-V	DIN 96x96 D96C90-V	ROTEX 72x72 R72C90-V
0 - 25 V	Reference 192G 5012	Reference 192G 5112	Reference	Reference 192G 6112
0 - 40 V	Reference 192G 5013	Reference 192G 5113	Reference 192G 5213	Reference 192G 6113
0 - 60 V	Reference 192G 5014	Reference 192G 5114	Reference 192G 5214	Reference 192G 6114
0 - 100 V	Reference 192G 5015	Reference	Reference 192G 5215	Reference 192G 6115
0 - 150 V	Reference 192G 5016	Reference 192G 5116	Reference 192G 5216	Reference 192G 6116
0 - 250 V		Reference 192G 5117		
0 - 400 V				Reference 192G 6119
0 - 500 V		Reference 192G 5120	Reference 192G 5220	

Accessories

	DIN 48x48 D48A90-A	DIN 72x72 D72A90-A	DIN 96x96 D96A90-A	ROTEX 72x72 R72A90-A
	Reference	Reference	Reference	Reference
Terminal protection cover		192Z 1000	192Z 1011	
2 safety caps	192Z 1016	192Z 1016	192Z 1016	192Z 1016
Mounting bracket and screws	179Z 5000	179Z 5010	179Z 5010	179Z 5020
Gasket	192Z 0007	192Z 0008	192Z 0009	192Z 0011
Replacement glass	179Z 2000	179Z 2010	179Z 2020	179Z 2030